

# MMG GREENS



**2&3 BHK**

**Independent Houses, Premium Houses**

@

**Near Christ Public School,**

**Rajarajeshwari Nagar, Bogadi, Mysuru**

**Coming With  
100 Houses**

**Site Dimensions**

**30x40 | 30x50  
| 30x35**

**Immediate  
Registration**

**Our all Project Approved  
With Syndicate Bank**

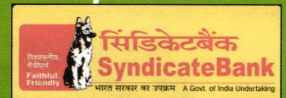

**Booking  
Open**

## Approximate Key Distance

Suburb Bus Stand	9.0 Kms
City Bus Stand	8.0 Kms
Railway Station	8.0 Kms
Ring Road	1.5 Kms
Hinkal Circle	6.0 Kms
Bogadi	3.0 Kms
Near Christ Public School	

## Layout Facilities

Plastic free environment  
Road Cutting free layout  
Underground water connections  
Wide roads, footpaths  
Closed drains  
Each plot with independence & water supply  
Electricity & Sewage Connections

## MMG CONSTRUCTIONS LLP

# 617, 1<sup>st</sup> Floor, New Kantharaja Urs Road, Near Vijaya Bank Circle, Kuvempunagar, Mysuru-570 023

web: [www.mmgconstructions.com](http://www.mmgconstructions.com) | e-mail: [sales@mmgconstructions.com](mailto:sales@mmgconstructions.com)

**Ph: 0821-4264309 | M: 9900486816/18/17/31/11/26**



**Exclusive MMG App**



# On Going Projects Booking Open

## MMG VB City



Near De Paul School,  
KRS-Hunsur Rd  
250 Individual &  
Row Houses  
Site Dimensions  
30x40 | 20x30

## MMG Ambari Enclave



Behind Mysuru Airport,  
Mandakalli  
50 Individual Houses  
Site Dimensions  
30x40 | 30x50

## Approved Layout Plan

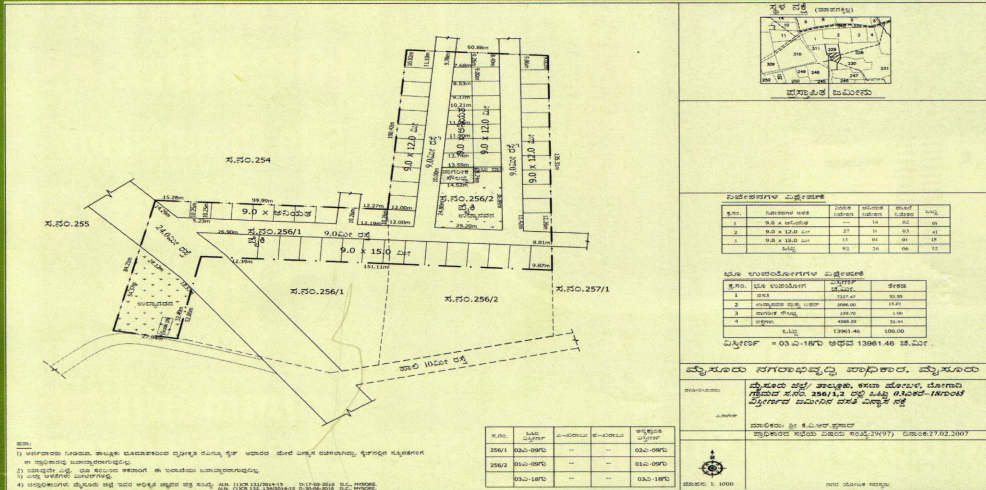

## CUSTOMERS ARE IN THE HEART OF OUR ORGANISATION



## Completed Projects :



**MMG Yeshwini Residency, Bogadi**  
35 Individual Houses



**MMG Aishwarya Royal, Bogadi**  
80 Individual & Row Houses



**MMG Century, Hootagally**  
100 Individual & Row Houses



**MMG Temple Bells, Srirampura**  
80 Individual & Row Houses



**MMG Prama Enclave, Srirampura**  
12 Individual Houses



**MMG SS Gardenia, Bogadi**  
50 Individual Houses

Land Owner:  
Sweet Mahesh V

## MAINTENANCE

Park, Water, Street Light, Tree Maintenance & Conditions apply\*